



Modular Drawer Cabinets

Available Standard Colors



Textured Putty



Textured Dove Gray

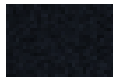

Textured Black



Textured Safety Yellow



Textured Cherry Red



Textured Regal Blue



Mirror Silver
(Wire Shelving Only)



Smooth Office Gray



Smooth Reflective White

Design Benefits & Features

- One-piece welded construction.
- Drawer capacity of up to 400 lbs.
- Highly-durable, attractive finishes.
- Tempered steel drawer bearings.
- High strength to weight ratio.

Space Utilization Advantages

- High-density storage maximizes cubic space.
- Stocking/retrieval of parts and tools is quick and efficient.
- Work areas are clean and neatly organized.
- Theft and slippage potential is reduced.

 **Material Handling USA**
800-326-4403
<https://www.mh-usa.com/>
Sales@MaterialHandling-USA.com

Market Applications

- Automotive - small parts and service tool storage.
- Maintenance - tool cribs and parts inventory.
- Military - mobile cabinet applications, service/maintenance divisions.
- Museum - small artifact storage and security

Modular Drawer Cabinets

Organize everything from the smallest hardware and jewelry to large motors and sporting equipment. Every heavy-duty Equipto Modular Drawer Cabinet is engineered and manufactured with exacting precision for years of rugged use. The optional lock keeps your items secure. Utilize "more than one drawer accessibility"

Industrial, Military, Educational, Institutional, Automotive; no matter what your application, Equipto modular drawer cabinets save space, time and money!

Applies to 30" and wider cabinets

- Organized
- Fast retrieval
- Save time
- High density
- Rugged 12 gauge steel frames
- Up to 400 lb. drawer capacity
- Protect valuable tools
- Centralized control of equipment
- No assembly
- Custom units
- Cabinet lock and key are optional (pg. 69)



Each drawer is ribbed and slotted (3/4" centers) over the length and width of the drawer. Convenient numbered spacings simplify installation of partitions, and label holders permit quick identification of drawer contents. When fully extended, 100% of the drawer clears frame to allow unobstructed viewing of entire drawer contents. The interchangeability of drawer partitions and dividers permits changing drawer interiors easily - as you need to, and in unlimited patterns.



Modular Drawer Cabinets

10-gauge side channels form a solid rail for mounting drawers.

Two positive-gravity stops riveted to each drawer carriage.

Adjustable channels permit flexibility in drawer arrangements and heights.

Independent, full extension carriage for each drawer; when fully extended, 100% of drawer clears frame.

"Z" shaped tracks on drawer edges are welded and wrapped under drawer bottom for superior durability.

Drawer suspensions glide on 6 ball bearings and 4 steel idler rollers to assure smooth, easy operation.

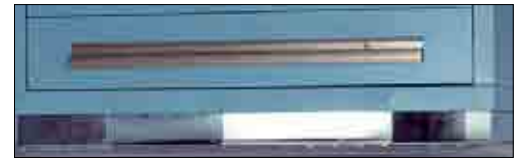
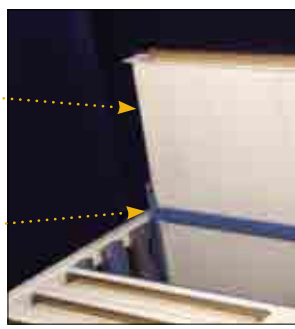

An integral fork lift base consisting of two 1 3/4" x 6" lifting channels arc-welded to the frame itself, permits inserting truck forks into wide channels for safe, easy transport of cabinets - even when fully loaded!

Anchor bolt

These bolting options allow you to anchor a modular drawer cabinet to either concrete or wood floors.



MDC-CFAK



MDC-WFAK

Part No.	Description
----------	-------------

MDC-CFAK	concrete anchor bolts
----------	-----------------------

MDC-WFAK	wood anchor bolts
----------	-------------------

22¹/₂" Wide Modular Drawer Cabinets

- 200 lbs. capacity per drawer
- Smooth, quiet drawer operation
- One piece welded frames
- Fork lift channels on base of cabinet
- Cabinet lock and key are optional (pg. 69)
- Electrostatic dissipative paint available
- 27³/₄" deep
- Drawer interior useable dimension is 18³/₄" W x 25¹/₈" D



Model 4294

22¹/₂" Wide Modular Drawer Cabinets - Preconfigured Units

22¹/₂" W x 27³/₄" D x 29" H

**4260H**

Drawer/Dividers included
(8) 3" h "H" Type
Order #4260 for unit
without divider kits.*

**4261H**

Drawer/Dividers included
(2) 3" h "H" Type
(4) 4.5" h "H" Type
Order #4261 for unit
without divider kits.*

**4262H**

Drawer/Dividers included
(2) 3" h "H" Type
(1) 6" h "H" Type
(1) 12" h "H" Type
Order #4262 for unit
without divider kits.*

**4263H**

Drawer/Dividers included
(1) 4.5" h "H" Type
(2) 6" h "H" Type
(1) 7.5" h "H" Type
Order #4263 for unit
without divider kits.*

**4264H**

Drawer/Dividers included
(4) 4.5" h "H" Type
(1) 6" h "H" Type
Order #4264 for unit
without divider kits.*

22¹/₂" W x 27³/₄" D x 33¹/₂" H

**4270H**

Drawer/Dividers included
(8) 3" h "H" Type
(1) 4.5" h "H" Type
Order #4270 for unit
without divider kits.*

**4271H**

Drawer/Dividers included
(2) 3" h "H" Type
(5) 4.5" h "H" Type
Order #4271 for unit
without divider kits.*

**4272H**

Drawer/Dividers included
(1) 3" h "H" Type
(1) 6" h "H" Type
(1) 7.5" h "H" Type
(1) 12" h "H" Type
Order #4272 for unit
without divider kits.*

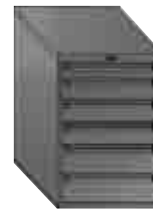
**4273H**

Drawer/Dividers included
(1) 3" h "H" Type
(3) 4.5" h "H" Type
(2) 6" h "H" Type
Order #4273 for unit
without divider kits.*

**4274H**

Drawer/Dividers included
(5) 4.5" h "H" Type
(1) 6" h "H" Type
Order #4274 for unit
without divider kits.*

Drawer divider options

* This 22¹/₂" wide pre-engineered modular drawer unit is also available with either all D, E, G, H or K divider kits (see page 55). To specify, simply add the letter suffix after the first four digits of cabinet model number when ordering. Drop any following digits. Ex: 4420 becomes 4420D.

A standard color chart is available at the beginning of each section with a more detailed one on page 126.

221/2" W x 273/4" D x 44" H



4280-01
 Drawer/Dividers included
 (6) 3" h "E" Type
 (7) 3" h "G" Type
 Order #4280 for unit
 without divider kits.*



4281-01
 Drawer/Dividers included
 (1) 3" h "E" Type
 (3) 4.5" h "E" Type
 (5) 4.5" h "G" Type
 Order #4281 for unit
 without divider kits.*



4282-01
 Drawer/Dividers included
 (1) 3" h "E" Type
 (3) 6" h "G" Type
 (3) 6" h "H" Type
 Order #4282 for unit
 without divider kits.*



4283-01
 Drawer/Dividers included
 (1) 7.5" h "H" Type
 (3) 3" h "E" Type
 (5) 4.5" h "G" Type
 Order #4283 for unit
 without divider kits.*



4284-01
 Drawer/Dividers included
 (3) 3" h "E" Type
 (1) 4.5" h "E" Type
 (1) 6" h "G" Type
 (1) 7.5" h "G" Type
 (1) 12" h "K" Type
 Order #4284 for unit
 without divider kits.*



4285-01
 Drawer/Dividers included
 (1) 7.5" h "E" Type
 (1) 9" h "G" Type
 (1) 10.5" h "G" Type
 (1) 12" h "K" Type
 Order #4285 for unit
 without divider kits.*



4286-01
 Drawer/Dividers included
 (3) 4.5" h "E" Type
 (3) 6" h "G" Type
 (1) 7.5" h "H" Type
 Order #4286 for unit
 without divider kits.*



4287-01
 Drawer/Dividers included
 (3) 4.5" h "E" Type
 (3) 4.5" h "G" Type
 (1) 12" h "K" Type
 Order #4287 for unit
 without divider kits.*



4288-01
 Drawer/Dividers included
 (2) 9" h "G" Type
 (2) 10.5" h "H" Type
 Order #4288 for unit
 without divider kits.*

Modular Drawer Cabinets

221/2" W x 273/4" D x 59" H



4290-01
 Drawer/Dividers included
 (9) 3" h "E" Type
 (9) 3" h "G" Type
 Order #4290 for unit
 without divider kits.*



4291-01
 Drawer/Dividers included
 (4) 4.5" h "E" Type
 (4) 4.5" h "G" Type
 (4) 4.5" h "H" Type
 Order #4291 for unit
 without divider kits.*



4292-01
 Drawer/Dividers included
 (3) 4.5" h "E" Type
 (6) 4.5" h "G" Type
 Order #4292 for unit
 without divider kits.*



4293-01
 Drawer/Dividers included
 (5) 3" h "E" Type
 (7) 4.5" h "G" Type
 (1) 7.5" h "G" Type
 Order #4293 for unit
 without divider kits.*



4294-01
 Drawer/Dividers included
 (3) 3" h "E" Type
 (3) 4.5" h "G" Type
 (2) 6" h "G" Type
 (1) 7.5" h "H" Type
 (1) 12" h "K" Type
 Order #4294 for unit
 without divider kits.*

Drawer divider options

* This 221/2" wide pre-engineered modular drawer unit is also available with either all D, G or H divider kits. To specify, simply add the letter suffix after the first four digits of cabinet model number when ordering. Drop any following digits. Ex: 4290-01 becomes 4290D.

A standard color chart is available at the beginning of each section with a more detailed one on page 126.

22 1/2" Wide Modular Drawer Cabinets - Preconfigured Units

22 1/2" W x 27 3/4" D x 59" H



4295-01
 Drawer/Dividers included
 (2) 7.5" h "E" Type
 (4) 7.5" h "G" Type
 (1) 9" h "H" Type
 Order #4295 for unit
 without divider kits.*



4296-01
 Drawer/Dividers included
 (3) 4.5" h "E" Type
 (3) 6" h "H" Type
 (3) 7.5" h "H" Type
 Order #4296 for unit
 without divider kits.*



4297-01
 Drawer/Dividers included
 (5) 6" h "G" Type
 (2) 7.5" h "H" Type
 (1) 9" h "H" Type
 Order #4297 for unit
 without divider kits.*



4298-01
 Drawer/Dividers included
 (1) 4.5" h "E" Type
 (3) 6" h "G" Type
 (3) 7.5" h "E" Type
 (1) 9" h "E" Type
 Order #4298 for unit
 without divider kits.*

Customizing a Modular Drawer Cabinet

22 1/2" Wide Modular Drawer Cabinets - Components

To customize an Equipto Modular Drawer Cabinet, first select a housing from the following options:

29" High, 33 1/2" High, 38" High, 44" High or 59" High

Housings

Part No.	Height	Points	Total Drawer	
			Height Value	Door Kits Part No.
4269	29"	80	24"	4269H - SWD
4279	33 1/2"	95	28 1/2"	4279H - SWD
4228	38"	110	33"	4228H - SWD
4289	44"	130	39"	4289H - SWD
4299	59"	180	54"	4299H - SWD

All housings are 22 1/2" Wide & 27 3/4" Deep



4269



4279



4228



4289

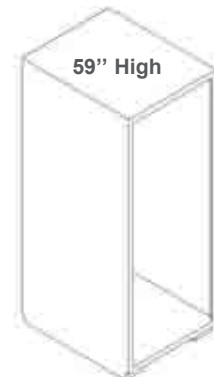

4299

Modular Drawer Cabinets



Lock-in Lock-out feature

RH Only (Add RH to Base Part Number – Ex: 8623-10 = 8623RH)

A standard color chart is available at the beginning of each section with a more detailed one on page 126.

Select The Drawers You Want To Put In The Housing.

(Keeping in mind the simple point system, in which the summation of the individual drawer points must equal the total points for the cabinet housing.)
 Interior useable dimensions on all drawers is 18³/₄" W x 25¹/₈" D

Drawers (200 lbs. Capacity per drawer)

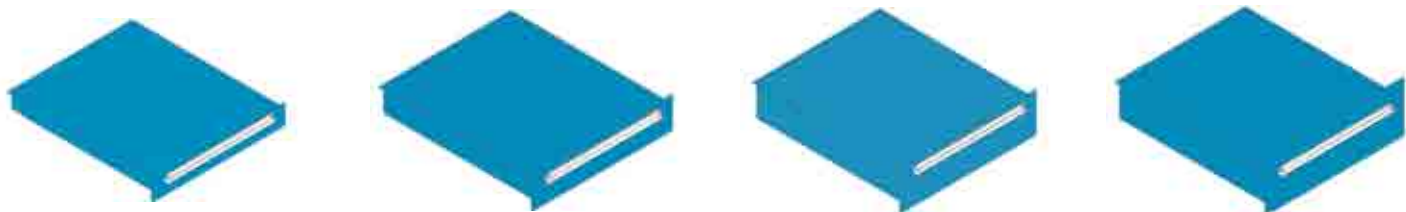

Part No.	Part No.	Part No.	Part No.
8623-10	8624-15	8625-20	8626-25
Height	Height	Height	Height
Front: 3"	Front: 4 ¹ / ₂ "	Front: 6"	Front: 7 ¹ / ₂ "
Body: 2 ¹ / ₈ "	Body: 3 ¹ / ₈ "	Body: 4 ⁵ / ₈ "	Body: 4 ⁵ / ₈ "
Useable: 2 ¹ / ₄ "	Useable: 3 ³ / ₄ "	Useable: 5 ¹ / ₄ "	Useable: 6 ³ / ₄ "
Points: 10	Points: 15	Points: 20	Points: 25



Part No.	Part No.	Part No.
8627-30	8628-35	8629-40
Height	Height	Height
Front: 9"	Front: 10 ¹ / ₂ "	Front: 12"
Body: 7 ⁵ / ₈ "	Body: 7 ⁵ / ₈ "	Body: 10 ⁵ / ₈ "
Useable: 8 ¹ / ₄ "	Useable: 9 ³ / ₄ "	Useable: 11 ¹ / ₄ "
Points: 30	Points: 35	Points: 40

Select divider sets for each drawer

that will help you maximize your storage space within each drawer.
 Divider Sets are optional, and are not required to order a cabinet.

Divider kits - 22¹/₂" wide - all dividers are smooth office gray in color

Divider Set	For 3" High Drawer	For 4 ¹ / ₂ " High Drawer	For 6" and 7 ¹ / ₂ " High Drawers	For 9" and 10 ¹ / ₂ " High Drawers	For 12" High Drawer	No. of Compartments
Type D	4163D10	4164D15	4165D20	4167D30	4169D40	17
Type E	4163E10	4164E15	4165E20	4167E30	4169E40	16
Type G	4163G10	4164G15	4165G20	4167G30	4169G40	9
Type H	4163H10	4164H15	4165H20	4167H30	4169H40	6
Type K	4163K10	4164K15	4165K20	4167K30	4169K40	4

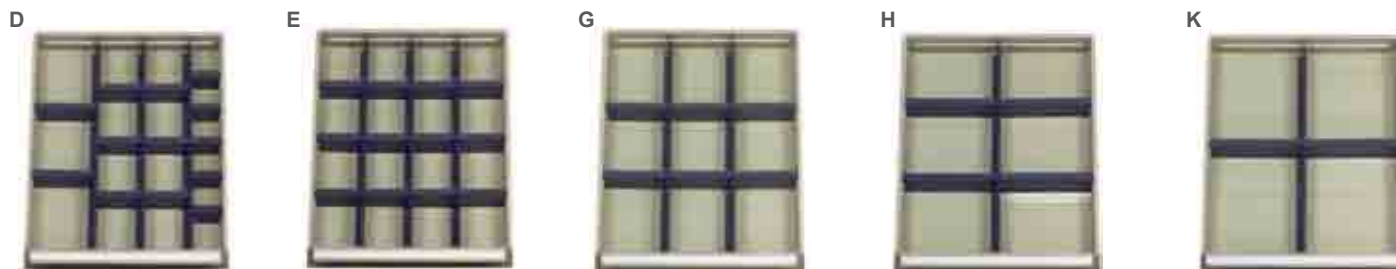

A standard color chart is available at the beginning of each section with a more detailed one on page 126.



Model 4431

30" Wide Modular Drawer Cabinets

- 400 pound capacity drawers
- 100% drawer extension
- One piece welded frames
- Fork lift channels on base of cabinet
- Cabinet lock and key are optional (pg. 69)
- 27³/₄" Deep
- Dividers are smooth office gray
- Drawer interior useable dimension is 18³/₄" W x 25¹/₈"

30" Wide Modular Drawer Cabinets - Preconfigured Units

30" W x 27³/₄" D x 29" H



4440H
Drawer/Dividers included
(8) 3" h "H" Type
Order #4440 for unit
without divider kits.*



4441H
Drawer/Dividers included
(2) 3" h "H" Type
(4) 4.5" h "H" Type
Order #4441 for unit
without divider kits.*



4442H
Drawer/Dividers included
(2) 3" h "H" Type
(1) 6" h "H" Type
(1) 12" h "H" Type
Order #4442 for unit
without divider kits.*



4443H
Drawer/Dividers included
(1) 4.5" h "H" Type
(2) 6" h "H" Type
(1) 7.5" h "H" Type
Order #4443 for unit
without divider kits.*



4444H
Drawer/Dividers included
(4) 4.5" h "H" Type
(1) 6" h "H" Type
Order #4444 for unit
without divider kits.*

30" W x 27³/₄" D x 33¹/₂" H



4430H
Drawer/Dividers included
(8) 3" h "H" Type
(1) 4.5" h "H" Type
Order #4430 for unit
without divider kits.*



4431H
Drawer/Dividers included
(2) 3" h "H" Type
(5) 4.5" h "H" Type
Order #4431 for unit
without divider kits.*



4432H
Drawer/Dividers included
(1) 3" h "H" Type
(1) 6" h "H" Type
(1) 7.5" h "H" Type
(1) 12" h "H" Type
Order #4432 for unit
without divider kits.*



4433H
Drawer/Dividers included
(1) 3" h "H" Type
(3) 4.5" h "H" Type
(2) 6" h "H" Type
Order #4433 for unit
without divider kits.*



4434H
Drawer/Dividers included
(5) 4.5" h "H" Type
(1) 6" h "H" Type
Order #4434 for unit
without divider kits.*

30" W x 27³/₄" D x 38" H

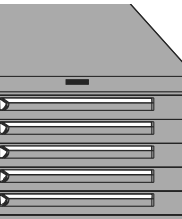

443038-512-01
Drawer/Dividers included
(5) 3" h "N" Type
(1) 4.5" h "R" Type
(1) 6.75" h "E" Type
(1) 6.75" h "F" Type
Order #443038-512MT
for unit without divider kits.



443038-412-01
Drawer/Dividers included
(4) 3" h "N" Type
(1) 4.5" h "R" Type
(1) 7.5" h "E" Type
(1) 9" h "F" Type
Order #443038-412MT
for unit without divider kits.



443038-042-01
Drawer/Dividers included
(4) 4.5" h "N" Type
(2) 7.5" h "N" Type
Order #443038-042MT
for unit without divider kits.



443038-005-01
Drawer/Dividers included
(1) 6" h "E" Type
(4) 6.75" h "E" Type
Order #443038-005MT
for unit without divider kits.

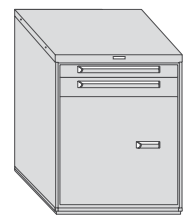

443038-11D-N
Drawer/Dividers included
(2) 4.5" h "N" Type
(1) 24" h Flush Cabinet Door
Order #443038-11DMT
for unit without divider kits.

Drawer divider options

*This 30" wide pre-engineered modular drawer unit is also available with either all A, B, C, D, E, F, G, H, K, L, M, N, P, R, or S divider kits (See page 59). To specify, simply add the letter suffix after the first four digits of cabinet model number when ordering. Drop any following digits. Ex: 4420-01 becomes 4420D.

A standard color chart is available at the beginning of each section with a more detailed one on page 126.

30" W x 27^{3/4}" D x 44" H



4410-01
 Drawer/Dividers included
 (3) 3" h "C" Type
 (6) 3" h "E" Type
 (4) 3" h "P" Type
 Order #4410 for unit
 without divider kits*



4411-01
 Drawer/Dividers included
 (1) 3" h "C" Type
 (3) 4.5" h "E" Type
 (2) 4.5" h "G" Type
 (3) 4.5" h "P" Type
 Order #4411 for unit
 without divider kits*



4412-01
 Drawer/Dividers included
 (1) 3" h "E" Type
 (3) 6" h "R" Type
 (3) 6" h "S" Type
 Order #4412 for unit
 without divider kits*



4413-01
 Drawer/Dividers included
 (1) 3" h "B" Type
 (2) 3" h "E" Type
 (3) 4.5" h "F" Type
 (2) 4.5" h "P" Type
 (1) 7.5" h "G" Type
 Order #4413 for unit
 without divider kits*



4414-01
 Drawer/Dividers included
 (3) 3" h "C" Type
 (1) 4.5" h "E" Type
 (1) 6" h "F" Type
 (1) 7.5" h "S" Type
 (1) 12" h "L" Type
 Order #4414 for unit
 without divider kits*



4415-01
 Drawer/Dividers included
 (1) 7.5" h "F" Type
 (1) 9" h "G" Type
 (1) 10.5" h "G" Type
 (1) 12" h "H" Type
 Order #4415 for unit
 without divider kits.



4416-01
 Drawer/Dividers included
 (3) 4.5" h "P" Type
 (3) 6" h "G" Type
 (1) 7.5" h "S" Type
 Order #4416 for unit
 without divider kits.



4417-01
 Drawer/Dividers included
 (3) 4.5" h "E" Type
 (3) 4.5" h "F" Type
 (1) 12" h "K" Type
 Order #4417 for unit
 without divider kits.



4418-01
 Drawer/Dividers included
 (2) 9" h "S" Type
 (2) 10.5" h "H" Type
 Order #4418 for unit
 without divider kits.

30" W x 27^{3/4}" D x 59" H

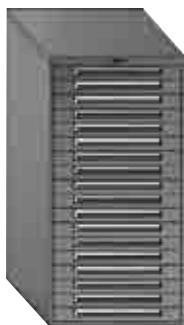

4420-01
 Drawer/Dividers included
 (3) 3" h "C" Type
 (5) 3" h "E" Type
 (5) 3" h "F" Type
 (5) 3" h "N" Type
 Order #4420 for unit
 without divider kits*



4421-01
 Drawer/Dividers included
 (4) 4.5" h "E" Type
 (4) 4.5" h "F" Type
 (4) 4.5" h "G" Type
 Order #4421 for unit
 without divider kits*



4422-01
 Drawer/Dividers included
 (9) 6" h "G" Type
 Order #4422 for unit
 without divider kits*



4423-01
 Drawer/Dividers included
 (2) 3" h "C" Type
 (3) 3" h "N" Type
 (3) 4.5" h "E" Type
 (4) 4.5" h "F" Type
 (1) 7.5" h "G" Type
 Order #4423 for unit
 without divider kits*



4424-01
 Drawer/Dividers included
 (3) 3" h "C" Type
 (3) 4.5" h "E" Type
 (2) 6" h "G" Type
 (1) 7.5" h "S" Type
 (1) 12" h "L" Type
 Order #4424 for unit
 without divider kits*

Drawer divider options

*This 30" wide pre-engineered modular drawer unit is also available with either all A, B, C, D, E, F, G, H, K, L, M, N, P, R, or S divider kits (See page 59). To specify, simply add the letter suffix after the first four digits of cabinet model number when ordering. Drop any following digits. Ex: 4420-01 becomes 4420D.

A standard color chart is available at the beginning of each section with a more detailed one on page 126.

Modular Drawer Cabinets

30'' Wide Modular Drawer Cabinets - Preconfigured Units

30'' W x 27³/₄'' D x 59'' H (400 lb. Capacity per drawer)



4425-01
 Drawer/Dividers included
 (4) 7.5''h "F" Type
 (2) 7.5''h "P" Type
 (1) 9''h "S" Type
 Order #4425 for unit
 without divider kits.



4426-01
 Drawer/Dividers included
 (1) 4.5''h "E" Type
 (2) 4.5''h "F" Type
 (3) 6''h "F" Type
 (2) 7.5''h "G" Type
 (1) 7.5''h "H" Type
 Order #4426 for unit
 without divider kits.



4427-01
 Drawer/Dividers included
 (3) 6''h "F" Type
 (2) 6''h "G" Type
 (2) 7.5''h "S" Type
 (1) 9''h "H" Type
 Order #4427 for unit
 without divider kits.



4428-01
 Drawer/Dividers included
 (1) 4.5''h "E" Type
 (3) 6''h "R" Type
 (3) 7.5''h "G" Type
 (1) 9''h "S" Type
 Order #4428 for unit
 without divider kits.

Customizing a Modular Drawer Cabinet

30'' Wide Modular Drawer Cabinets - Components

To customize an Equipto Modular Drawer Cabinet, first select a housing from the following options:

29'' High, 33¹/₂'' High, 38'' High, 44'' High or 59'' High

Housings

Part No.	Height	Points	Total Drawer Height Value
4439	29''	80	24''
4429	33 ¹ / ₂ ''	95	28 ¹ / ₂ ''
4238	38''	110	33''
4409	44''	130	39''
4419	59''	180	54''

All housings are 30'' W & 27³/₄'' D



4439



4429

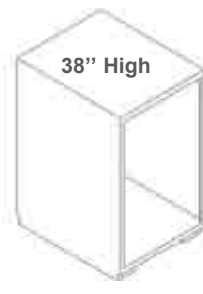

4238



4409

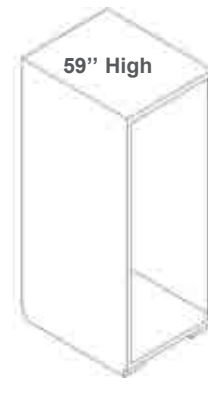

4419

Modular Drawer Cabinets



Lock-in Lock-out feature

RH Only (Add RH to Base Part Number – Ex: 8623-10 = 8623RH)

A standard color chart is available at the beginning of each section with a more detailed one on page 126.

Select The Drawers You Want To Put In The Housing.

(Keeping in mind the simple point system, in which the summation of the individual drawer points must equal the total points for the cabinet housing.)

Drawer interior useable dimension is 18³/₄" W x 25¹/₈" D

Drawers (400 lbs. Capacity per drawer)

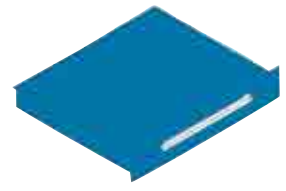
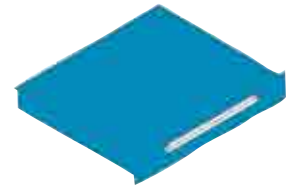
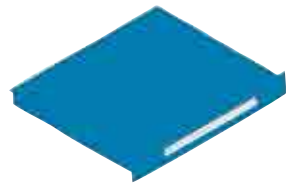
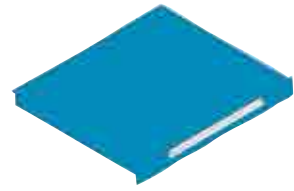

Part No.	Part No.	Part No.	Part No.
8633-10	8633T-12.5	8634-15	8634T-17.5
Height	Height	Height	Height
Front: 3"	Front: 3 ³ / ₄ "	Front: 4 ¹ / ₂ "	Front: 5 ¹ / ₄ "
Body: 2 ¹ / ₈ "	Body: 2 ¹ / ₈ "	Body: 3 ¹ / ₈ "	Body: 3 ¹ / ₈ "
Useable: 2 ¹ / ₄ "	Useable: 3"	Useable: 3 ³ / ₄ "	Useable: 4 ¹ / ₂ "
Points: 10	Points: 12.5	Points: 15	Points: 17.5

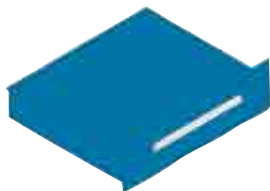
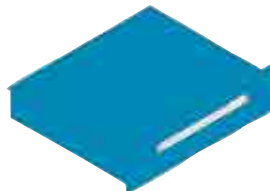
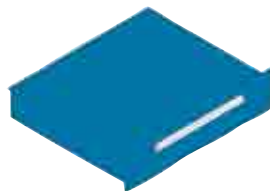
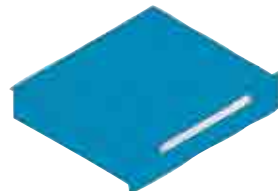

Part No.	Part No.	Part No.	Part No.
8635-20	8635T-22.5	8636-25	8636T-27.5
Height	Height	Height	Height
Front: 6"	Front: 6 ³ / ₄ "	Front: 7 ¹ / ₂ "	Front: 8 ¹ / ₄ "
Body: 4 ⁵ / ₈ "	Body: 4 ⁵ / ₈ "	Body: 4 ⁵ / ₈ "	Body: 4 ⁵ / ₈ "
Useable: 5 ¹ / ₄ "	Useable: 6"	Useable: 6 ³ / ₄ "	Useable: 7 ¹ / ₂ "
Points: 20	Points: 22.5	Points: 25	Points: 27.5

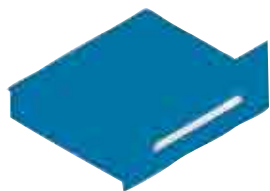
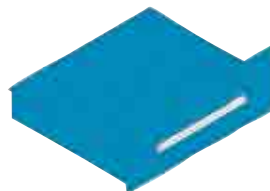
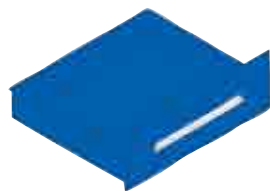
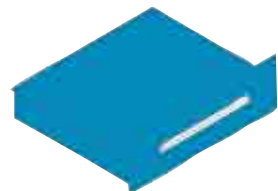

Part No.	Part No.	Part No.	Part No.
8637-30	8637T-32.5	8638-35	8638T-37.5
Height	Height	Height	Height
Front: 9"	Front: 9 ³ / ₄ "	Front: 10 ¹ / ₂ "	Front: 11 ¹ / ₄ "
Body: 4 ⁵ / ₈ "	Body: 4 ⁵ / ₈ "	Body: 4 ⁵ / ₈ "	Body: 4 ⁵ / ₈ "
Useable: 8 ¹ / ₄ "	Useable: 9"	Useable: 9 ³ / ₄ "	Useable: 10 ¹ / ₂ "
Points: 30	Points: 32.5	Points: 35	Points: 37.5

A standard color chart is available at the beginning of each section with a more detailed one on page 126.

Modular Drawer Cabinets

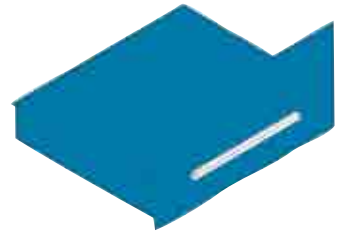
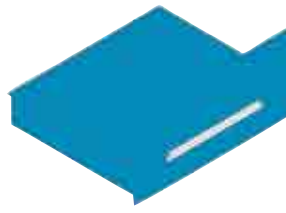
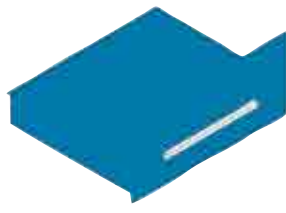
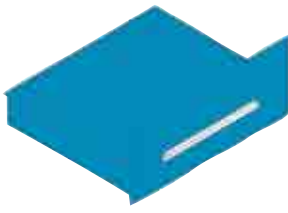

Part No.	Part No.	Part No.	Part No.
8639-40	8639T-42.5	8640-45	8640T-47.5
Height	Height	Height	Height
Front: 12"	Front: 12 ³ / ₄ "	Front: 13 ¹ / ₂ "	Front: 14 ¹ / ₄ "
Body: 4 ⁵ / ₈ "	Body: 4 ⁵ / ₈ "	Body: 4 ⁵ / ₈ "	Body: 4 ⁵ / ₈ "
Useable: 11 ¹ / ₄ "	Useable: 12"	Useable: 12 ³ / ₄ "	Useable: 13 ¹ / ₂ "
Points: 40	Points: 42.5	Points: 45	Points: 47.5

Select divider sets for each drawer

that will help you maximize your storage space within each drawer. Divider Sets are optional, and are not required to order a cabinet. Dividers are smooth office gray in color.

Divider kits - 30" wide

Divider Set	For 3" High Drawer	For 4 ¹ / ₂ " High Drawer	For 6" High and Up Drawer
Type A	4133A10	4134A15	4135A20
Type B	4133B10	4134B15	4135B20
Type C	4133C10	4134C15	4135C20
Type D	4133D10	4134D15	4135D20
Type E	4133E10	4134E15	4135E20
Type F	4133F10	4134F15	4135F20
Type G	4133G10	4134G15	4135G20
Type H	4133H10	4134H15	4135H20
Type K	4133K10	4134K15	4135K20
Type L	4133L10	4134L15	4135L20
Type M	4133M10	4134M15	4135M20
Type N	4133N10	4134N15	4135N20
Type P	4133P10	4134P15	4135P20
Type R	4133R10	4134R15	4135R20
Type S	4133S10	4134S15	4135S20

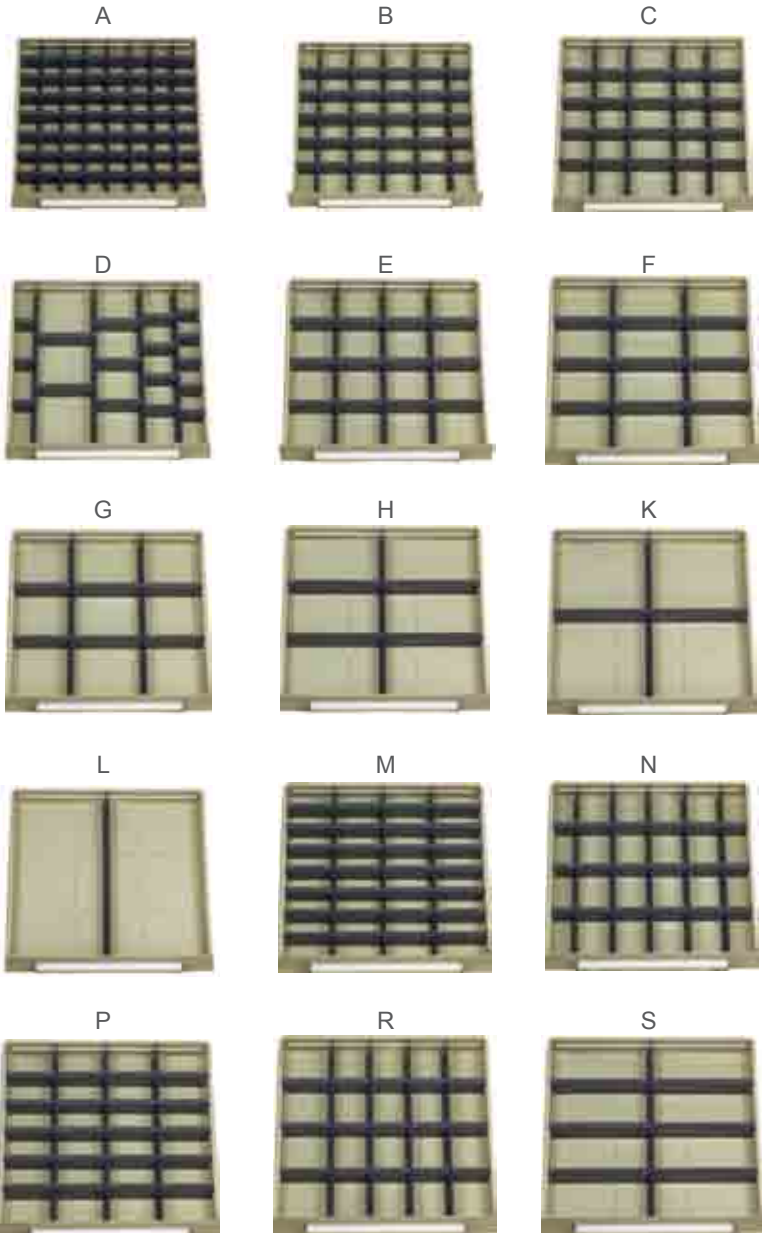

Modular Drawer Cabinets

A standard color chart is available at the beginning of each section with a more detailed one on page 126.

36⁷/₈" Wide Modular Drawer Cabinets

- Use these modular drawer cabinets to organize more of your items in less floor space.
- High quality welded steel construction
- Precision engineered
- 200 pound capacity per drawer**
- 100% drawer extension
- Saves time
- Cabinet lock and key are optional (pg. 69)
- Choose from Quiet-Ride™ or Heavy Duty Drawers



36⁷/₈" Wide Modular Drawer Cabinets - Preconfigured Units

36⁷/₈" W x 19 or 25" D x 44" H



4330D18N (19"D)
4330D24N (25"D)
 Drawer/Dividers included (13) 3"h "D" Type
 Order #4330-24N or 4330-18N for unit without divider kits.*



4331D18N (19"D)
4331D24N (25"D)
 Drawer/Dividers included (1) 3"h "D" Type (8) 4.5"h "D" Type
 Order #4331-24N or 4331-18N for unit without divider kits.*



4332D18N (19"D)
4332D24N (25"D)
 Drawer/Dividers included (1) 3"h "D" Type (6) 6"h "D" Type
 Order #4332-24N or 4332-18N for unit without divider kits.*



4333D18N (19"D)
4333D24N (25"D)
 Drawer/Dividers included (3) 3"h "D" Type (5) 4.5"h "D" Type (1) 7.5"h "D" Type
 Order #4333-24N or 4333-18N for unit without divider kits.*



4334D18N (19"D)
4334D24N (25"D)
 Drawer/Dividers included (3) 3"h "D" Type (1) 4.5"h "D" Type (1) 6"h "D" Type (1) 7.5"h "D" Type (1) 12"h "D" Type
 Order #4334-24N or 4334-18N for unit without divider kits.*

36⁷/₈" W x 19 or 25" D x 59" H



4340D18N (19"D)
4340D24N (25"D)
 Drawer/Dividers included (18) 3"h "D" Type
 Order #4340-24N or 4340-18N for unit without divider kits.*



4341D18N (19"D)
4341D24N (25"D)
 Drawer/Dividers included (12) 4.5"h "D" Type
 Order #4341-24N or 4341-18N for unit without divider kits.*



4342D18N (19"D)
4342D24N (25"D)
 Drawer/Dividers included (9) 6"h "D" Type
 Order #4342-24N or 4342-18N for unit without divider kits.*



4343D18N (19"D)
4343D24N (25"D)
 Drawer/Dividers included (5) 3"h "D" Type (7) 4.5"h "D" Type (1) 7.5"h "D" Type
 Order #4343-24N or 4343-18N for unit without divider kits.*



4344D18N (19"D)
4344D24N (25"D)
 Drawer/Dividers included (3) 3"h "D" Type (3) 4.5"h "D" Type (2) 6"h "D" Type (1) 7.5"h "D" Type (1) 12"h "D" Type
 Order #4344-24N or 4344-18N for unit without divider kits.*

Drawer divider options

*36⁷/₈" wide pre-engineered modular drawer units are also available with either all D, E, F or H divider kits. To order, change "D" in part number to desired divider kit letter. **Above units feature Quiet Ride™ 200 pound capacity drawers. To order Heavy Duty 400 pound capacity drawers, replace "N" with "H" in catalog number.

A standard color chart is available at the beginning of each section with a more detailed one on page 126.

Modular Drawer Cabinets

Customizing a Modular Drawer Cabinet

36⁷/₈" W x 19" or 25" D Modular Drawer Cabinets - Components

To customize an Equipto Modular Drawer Cabinet, first select a housing from the following options:

29" High, 33¹/₂" High, 38" High, 44" High or 59" High

Housings 19" Deep

Part No.	Height	Points	Total Drawer Height Value
4309-18	29"	80	24"
4319-18	33 ¹ / ₂ "	95	28 ¹ / ₂ "
4359-18	38"	110	33"
4329-18	44"	130	39"
4339-18	59"	180	54"

Useable drawer space is 31⁷/₁₆" W x 17¹/₁₆" D

Housings 25" Deep

Part No.	Height	Points	Total Drawer Height Value
4309-24	29"	80	24"
4319-24	33 ¹ / ₂ "	95	28 ¹ / ₂ "
4359-24	38"	110	33"
4329-24	44"	130	39"
4339-24	59"	180	54"

Useable drawer space is 31⁷/₁₆" W x 22¹/₈" D

All housings are 36⁷/₈" Wide & 19 or 25" Deep

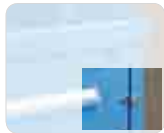
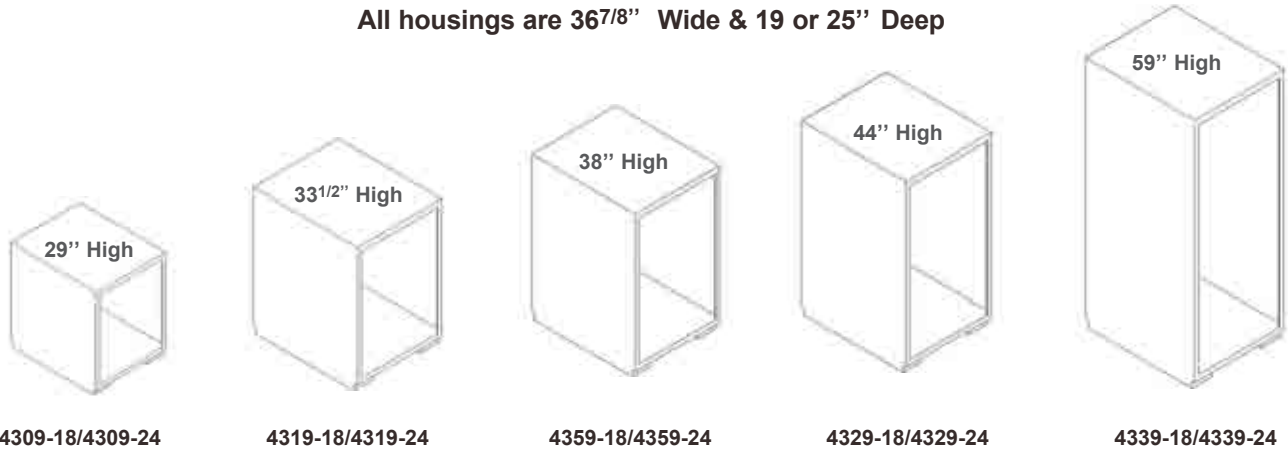

Lock-in Lock-out feature

RH Only (Add RH to Base Part Number – Ex: 8603CH to 8603CHRH)

Select The Drawers You Want To Put In The Housing.

(Keeping in mind the simple point system, in which the summation of the individual drawer points must equal the total points for the cabinet housing.)

Drawers (400 lbs. Capacity per drawer)

To order 200 pound capacity drawers, replace "H" with an "N" in catalog number.

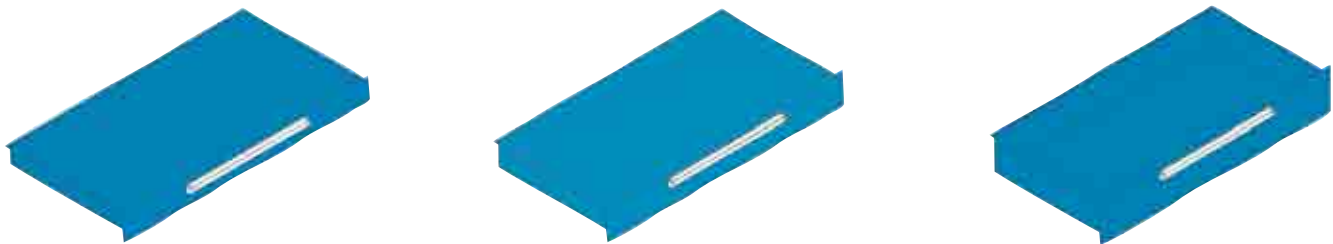

Part No. 19"D	Part No. 25"D	Part No. 19"D	Part No. 25"D	Part No. 19"D	Part No. 25"D
8603CH	8610CH	8604CH	8611CH	8605CH	8612CH
Height	Height	Height	Height	Height	Height
Front: 3"	Front: 3"	Front: 4 ¹ / ₂ "	Front: 4 ¹ / ₂ "	Front: 6"	Front: 6"
Body: 2 ¹ / ₈ "	Body: 2 ¹ / ₈ "	Body: 3 ¹ / ₈ "	Body: 3 ¹ / ₈ "	Body: 4 ⁵ / ₈ "	Body: 4 ⁵ / ₈ "
Useable: 2 ¹ / ₄ "	Useable: 2 ¹ / ₄ "	Useable: 3 ³ / ₄ "	Useable: 3 ³ / ₄ "	Useable: 5 ¹ / ₄ "	Useable: 5 ¹ / ₄ "
Points: 10	Points: 10	Points: 15	Points: 15	Points: 20	Points: 20

A standard color chart is available at the beginning of each section with a more detailed one on page 126.

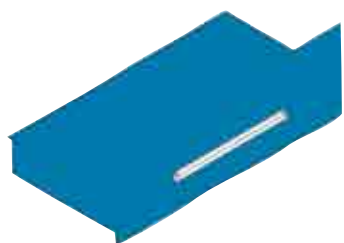
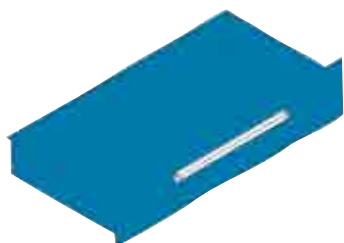

Part No. 19"D	Part No. 25"D	Part No. 19"D	Part No. 25"D	Part No. 19"D	Part No. 25"D
8606CH	8613CH	8601CH	8615CH	8602CH	8616CH
Height	Height	Height	Height	Height	Height
Front: 7 1/2"	Front: 7 1/2"	Front: 9"	Front: 9"	Front: 10 1/2"	Front: 10 1/2"
Body: 4 5/8"	Body: 4 5/8"	Body: 7 5/8"	Body: 7 5/8"	Body: 7 5/8"	Body: 7 5/8"
Useable: 6 3/4"	Useable: 6 3/4"	Useable: 8 1/4"	Useable: 8 1/4"	Useable: 9 3/4"	Useable: 9 3/4"
Points: 25	Points: 25	Points: 30	Points: 30	Points: 35	Points: 35

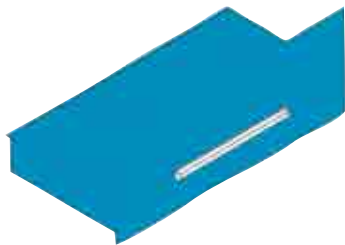
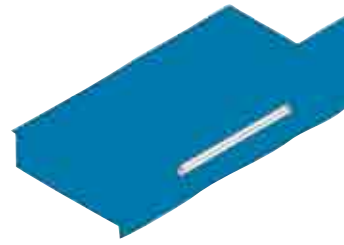

Part No. 19"D	Part No. 25"D	Part No. 19"D	Part No. 25"D
8607CH	8614CH	8608CH	8617CH
Height	Height	Height	Height
Front: 12"	Front: 12"	Front: 13 1/2"	Front: 13 1/2"
Body: 10 5/8"	Body: 10 5/8"	Body: 10 5/8"	Body: 10 5/8"
Useable: 11 1/4"	Useable: 11 1/4"	Useable: 12 3/4"	Useable: 12 3/4"
Points: 40	Points: 40	Points: 45	Points: 45

Modular Drawer Cabinets

Select divider sets for each drawer

that will help you maximize your storage space within each drawer. Divider Sets are optional, and are not required to order a cabinet. All dividers are smooth office gray in color.

Divider kits - 19" deep, 36" wide

Divider Set	For 3" High Drawer	For 4 1/2" High Drawer	For 6" High and Up Drawer
Type D	4173D10	4174D15	4175D20
Type F	4173F10	4174F15	4175F20
Type H	4173H10	4174H15	4175H20

Divider kits - 25" deep, 36" wide

Divider Set	For 3" High Drawer	For 4 1/2" High Drawer	For 6" High and Up Drawer
Type D	4183D10	4184D15	4185D20
Type F	4183F10	4184F15	4185F20
Type H	4183H10	4184H15	4185H20

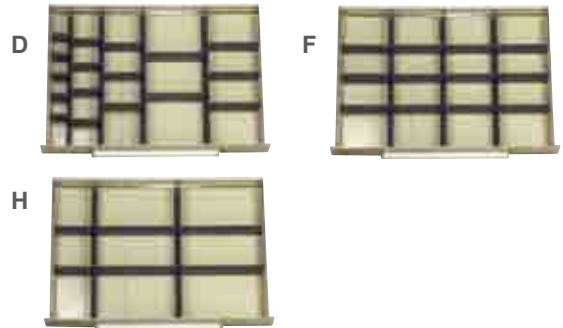
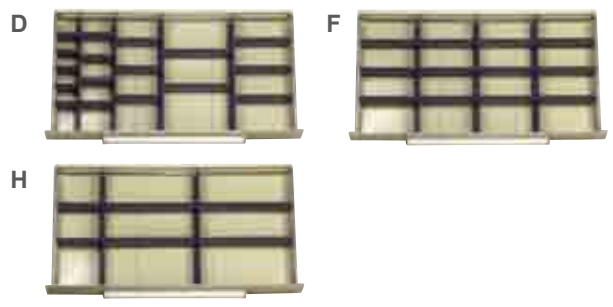

A standard color chart is available at the beginning of each section with a more detailed one on page 126.

45" Wide Modular Drawer Cabinets

- Use these modular drawer cabinets to organize more of your items in less floor space.
- High quality welded steel construction
- Precision engineered
- 400 pound capacity per drawer
- 100% drawer extension
- Saves time
- Cabinet lock and key are optional (pg. 69)



Model 4484

45" Wide Modular Drawer Cabinets - Preconfigured Units

45" W x 27³/₄" D x 38" H

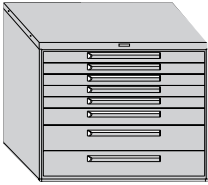

444538-512-01

Drawer/Dividers included
 (5) 3" h "C" Type
 (1) 4.5" h "C" Type
 (1) 6.75" h "C" Type
 (1) 6.75" h "E" Type
 Order #444538-512MT
 for unit without divider kits.

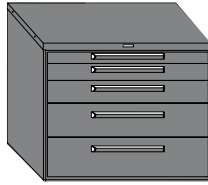

444538-113-01

Drawer/Dividers included
 (1) 3" h "C" Type
 (1) 4.5" h "C" Type
 (1) 6" h "E" Type
 (1) 9" h "E" Type
 (1) 10.5" h "F" Type
 Order #444538-113MT
 for unit without divider kits.



444538-999-01

Drawer/Dividers included
 (1) 3" h "C" Type
 (1) 4.5" h "C" Type
 (1) 6" h "C" Type
 (1) 6.75" h "E" Type
 (1) 12.75" h "F" Type
 Order #444538-999MT
 for unit without divider kits.



444538-004-01

Drawer/Dividers included
 (2) 8.25" h "E" Type
 (1) 8.25" h "C" Type
 (1) 8.25" h "H" Type
 Order #444538-004MT
 for unit without divider kits.

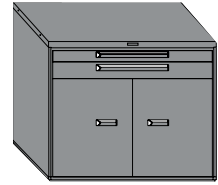

444538-11D-E

Drawer/Dividers included
 (1) 3" h "E" Type
 (1) 4.5" h "E" Type
 (1) 24" h Flush Cabinet Door
 has a 5 point security channel
 Order #444538-11DMT
 for unit without divider kits.

45" W x 27³/₄" D x 44" H



4470H

Drawer/Dividers included
 (13) 3" h "H" Type
 Order #4470 for unit
 without divider kits.



4471H

Drawer/Dividers included
 (1) 3" h "H" Type
 (8) 4.5" h "H" Type
 Order #4471 for unit
 without divider kits.



4472H

Drawer/Dividers included
 (1) 3" h "H" Type
 (6) 6" h "H" Type
 Order #4472 for unit
 without divider kits.



4473H

Drawer/Dividers included
 (3) 3" h "H" Type
 (5) 4.5" h "H" Type
 (1) 7.5" h "H" Type
 Order #4473 for unit
 without divider kits.



4474H

Drawer/Dividers included
 (3) 3" h "H" Type
 (1) 4.5" h "H" Type
 (1) 6" h "H" Type
 (1) 7.5" h "H" Type
 (1) 12" h "H" Type
 Order #4474 for unit
 without divider kits.

Drawer divider options

*This 45" wide pre-engineered modular drawer unit is also available with either all D, E, F or H divider kits (See page 64). To specify, simply add the letter suffix after the first four digits of cabinet model number when ordering. Drop any following digits. Ex: 4480 becomes 4480D.

A standard color chart is available at the beginning of each section with a more detailed one on page 126.

45" W x 27³/₄" D x 59" H



4480H
Drawer/Dividers included
(18) 3" h "H" Type
Order #4480 for unit
without divider kits.



4481H
Drawer/Dividers included
(12) 4.5" h "H" Type
Order #4481 for unit
without divider kits.



4482H
Drawer/Dividers included
(9) 6" h "H" Type
Order #4482 for unit
without divider kits.



4483H
Drawer/Dividers included
(5) 3" h "H" Type
(7) 4.5" h "H" Type
(1) 7.5" h "H" Type
Order #4483 for unit
without divider kits.



4484H
Drawer/Dividers included
(3) 3" h "H" Type
(3) 4.5" h "H" Type
(2) 6" h "H" Type
(1) 7.5" h "H" Type
(1) 12" h "H" Type
Order #4484 for unit
without divider kits.

Customizing a Modular Drawer Cabinet

45" W x 27³/₄" D Modular Drawer Cabinets - Components

To customize an Equipto Modular Drawer Cabinet, first select a housing from the following options:

29" High, 33¹/₂" High, 38" High, 44" High or 59" High

Housings

Part No.	Height	Points	Total Drawer Height Value
44369-18	29"	80	24"
44369	33 ¹ / ₂ "	95	28 ¹ / ₂ "
4248	38"	110	33"
4469	44"	130	39"
4479	59"	180	54"

All housings are 45" Wide & 27³/₄" Deep



44369-18



44369



4248



4469

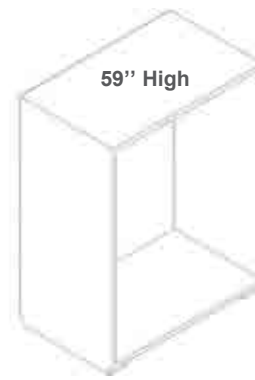

4479

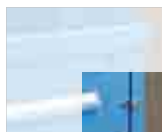

Lock-in Lock-out feature

RH Only (Add RH to Base Part Number – Ex: 8643-10 to 8643-10RH)

Drawer divider options

*This 45" wide pre-engineered modular drawer unit is also available with either or all D, E, F or H divider kits (See page 62). To specify, simply add the letter suffix after the first four digits of cabinet model number when ordering. Drop any following digits. Ex: 4480 becomes 4480D.

A standard color chart is available at the beginning of each section with a more detailed one on page 126.

Select The Drawers You Want To Put In The Housing.

(Keeping in mind the simple point system, in which the summation of the individual drawer points must equal the total points for the cabinet housing.)

Useable interior drawer space is 40¹/₈" W x 25¹/₈" D

Drawers (400 lbs. Capacity per drawer)

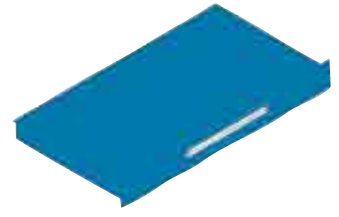
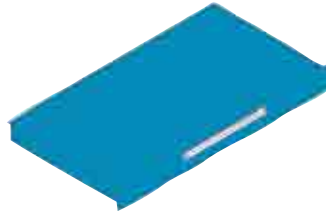
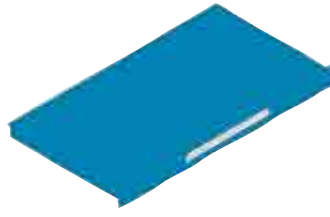
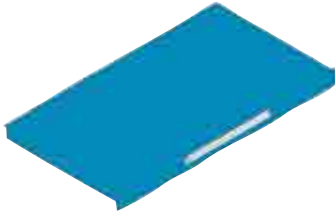

Part No.	Part No.	Part No.	Part No.
8643-10	8643T-12.5	8644-15	8644T-17.5
Height	Height	Height	Height
Front: 3"	Front: 3 ³ / ₄ "	Front: 4 ¹ / ₂ "	Front: 5 ¹ / ₄ "
Body: 2 ¹ / ₈ "	Body: 2 ¹ / ₈ "	Body: 3 ¹ / ₈ "	Body: 3 ¹ / ₈ "
Useable: 2 ¹ / ₄ "	Useable: 3"	Useable: 3 ³ / ₄ "	Useable: 4 ¹ / ₂ "
Points: 10	Points: 12.5	Points: 15	Points: 17.5

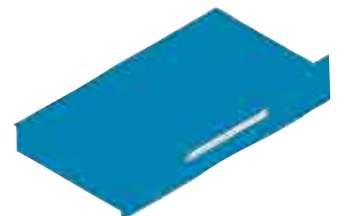
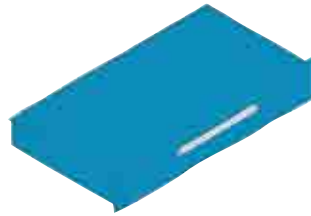
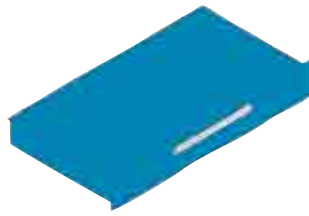
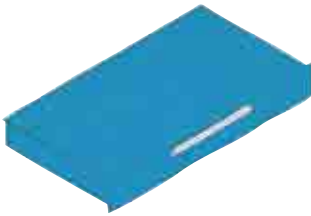

Part No.	Part No.	Part No.	Part No.
8645-20	8645T-22.5	8646-25	8646T-27.5
Height	Height	Height	Height
Front: 6"	Front: 6 ³ / ₄ "	Front: 7 ¹ / ₂ "	Front: 8 ¹ / ₄ "
Body: 4 ⁵ / ₈ "	Body: 4 ⁵ / ₈ "	Body: 4 ⁵ / ₈ "	Body: 4 ⁵ / ₈ "
Useable: 5 ¹ / ₄ "	Useable: 6"	Useable: 6 ³ / ₄ "	Useable: 7 ¹ / ₂ "
Points: 20	Points: 22.5	Points: 25	Points: 27.5

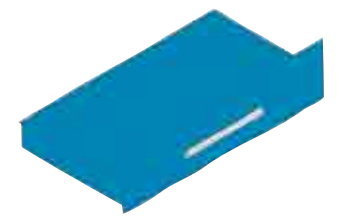
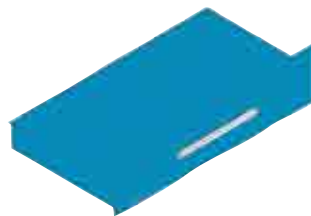
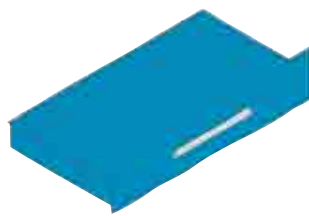
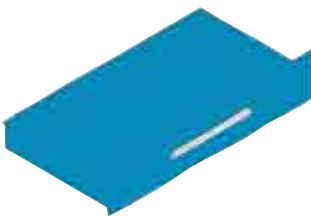

Part No.	Part No.	Part No.	Part No.
8647-30	8647T-32.5	8648-35	8648T-37.5
Height	Height	Height	Height
Front: 9"	Front: 9 ³ / ₄ "	Front: 10 ¹ / ₂ "	Front: 11 ¹ / ₄ "
Body: 4 ⁵ / ₈ "	Body: 4 ⁵ / ₈ "	Body: 4 ⁵ / ₈ "	Body: 4 ⁵ / ₈ "
Useable: 8 ¹ / ₄ "	Useable: 9"	Useable: 9 ³ / ₄ "	Useable: 10 ¹ / ₂ "
Points: 30	Points: 32.5	Points: 35	Points: 37.5

Modular Drawer Cabinets

A standard color chart is available at the beginning of each section with a more detailed one on page 126.

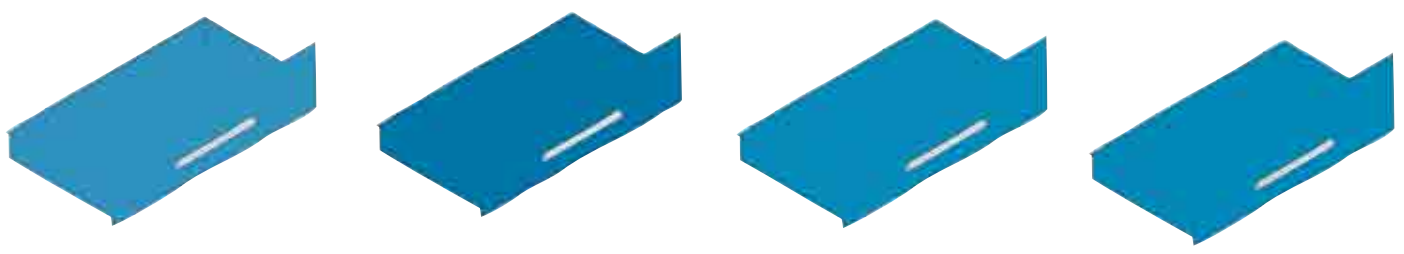

Part No.	Part No.	Part No.	Part No.
8649-40	8649T-42.5	8650-45	8650T-47.5
Height	Height	Height	Height
Front: 12"	Front: 12 ³ / ₄ "	Front: 13 ¹ / ₂ "	Front: 14 ¹ / ₄ "
Body: 4 ⁵ / ₈ "	Body: 4 ⁵ / ₈ "	Body: 4 ⁵ / ₈ "	Body: 4 ⁵ / ₈ "
Useable: 11 ¹ / ₄ "	Useable: 12"	Useable: 12 ³ / ₄ "	Useable: 13 ¹ / ₂ "
Points: 40	Points: 42.5	Points: 45	Points: 47.5

Select divider sets for each drawer

that will help you maximize your storage space within each drawer.

Divider Sets are optional, and are not required to order a cabinet.

All dividers are smooth office gray in color.



Divider kits - 45" wide

Divider Set	For 3" High Drawer	For 4 ¹ / ₂ " High Drawer	For 6" High and Up Drawer
Type C	4143C10	4144C15	4145C20
Type D	4143D10	4144D15	4145D20
Type E	4143E10	4144E15	4145E20
Type F	4143F10	4144F15	4145F20
Type H	4143H10	4144H15	4145H20

Modular Drawer Cabinets

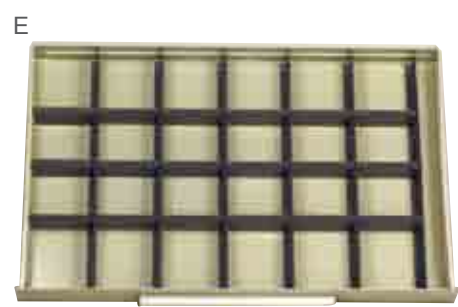

A standard color chart is available at the beginning of each section with a more detailed one on page 126.

60" Wide Modular Drawer Cabinets

- Use these modular drawer cabinets to organize more of your items in less floor space.
- High quality welded steel construction
- Precision engineered
- Saves time
- 400 pound capacity per drawer
- 100% drawer extension
- Cabinet lock and key are optional (pg. 69)
- Lifting Base Cover available (#6835)



Model 4461

60" Wide Modular Drawer Cabinets - Preconfigured Units

60" W x 27³/₄" D x 38" H



446038-222-01

Drawer/Dividers included
 (2) 3" h "C" Type
 (2) 4.5" h "C" Type
 (1) 7.5" h "C" Type
 (1) 10.5" h "F" Type
 Order #446038-222MT
 for unit without divider kits.

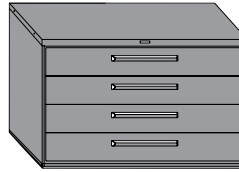

446038-004-E

Drawer/Dividers included
 (4) 8.25" h "E" Type
 Order #446038-004MT
 for unit without divider kits.

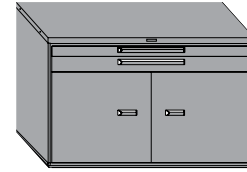

446038-11D-E

Drawer/Dividers included
 (1) 3" h "E" Type
 (1) 4.5" h "E" Type
 (1) 24" h Flush Cabinet Door has a 5 point security channel.
 Order #446038-11DMT
 for unit without divider kits.

60" W x 27³/₄" D x 44" H



4450H

Drawer/Dividers included
 (13) 3" h "H" Type
 Order #4450 for unit
 without divider kits*



4451H

Drawer/Dividers included
 (1) 3" h "H" Type
 (8) 4.5" h "H" Type
 Order #4451 for unit
 without divider kits.*



4452H

Drawer/Dividers included
 (1) 3" h "H" Type
 (6) 6" h "H" Type
 Order #4452 for unit
 without divider kits.*



4453H

Drawer/Dividers included
 (3) 3" h "H" Type
 (5) 4.5" h "H" Type
 (1) 7.5" h "H" Type
 Order #4453 for unit
 without divider kits.*



4454H

Drawer/Dividers included
 (3) 3" h "H" Type
 (1) 4.5" h "H" Type
 (1) 6" h "H" Type
 (1) 7.5" h "H" Type
 (1) 12" h "H" Type
 Order #4454 for unit
 without divider kits.*

Drawer divider options

*This 60" wide pre-engineered modular drawer unit is also available with all C, D, E, F or H divider kits (See page 67).

To specify, simply add the letter suffix after the first four digits of cabinet model number when ordering.

Drop any following digits. Ex: 4480 becomes 4480D.

60" W x 27³/₄" D x 59" H



4460H
Drawer/Dividers included
(18) 3" h "H" Type
Order #4460 for unit
without divider kits.*



4461H
Drawer/Dividers included
(12) 4.5" h "H" Type
Order #4461 for unit
without divider kits.*



4462H
Drawer/Dividers included
(9) 6" h "H" Type
Order #4462 for unit
without divider kits.*



4463H
Drawer/Dividers included
(5) 3" h "H" Type
(7) 4.5" h "H" Type
(1) 7.5" h "H" Type
Order #4463 for unit
without divider kits.*



4464H
Drawer/Dividers included
(3) 3" h "H" Type
(3) 4.5" h "H" Type
(2) 6" h "H" Type
(1) 7.5" h "H" Type
(1) 12" h "H" Type
Order #4464 for unit
without divider kits.*

Drawer divider options

*This 60" wide pre-engineered modular drawer unit is also available with either all D, E, F or H divider kits (See page 66). To specify, simply add the letter suffix after the first four digits of cabinet model number when ordering. Drop any following digits. Ex: 4480 becomes 4480D.



Lock-in Lock-out feature

RH Only (Add RH to Base Part Number – Ex: 8653-10 to 8653-10RH)

Customizing a Modular Drawer Cabinet

60" W x 27³/₄" D Modular Drawer Cabinets - Components

To customize an Equipto Modular Drawer Cabinet, first select a housing from the following options:

29" High, 33¹/₂" High, 38" High, 44" High or 59" High

Housings

Part No.	Height	Points	Total Drawer Height Value
4458	29"	80	24"
4468	33 ¹ / ₂ "	95	28 ¹ / ₂ "
4258	38"	110	33"
4449	44"	130	39"
4459	59"	180	54"

All housings are 60" Wide & 27³/₄" Deep

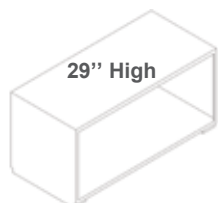

4458



4468



4258



4449

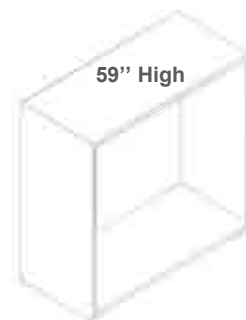

4459

A standard color chart is available at the beginning of each section with a more detailed one on page 126.

Select The Drawers You Want To Put In The Housing

(Keeping in mind the simple point system, in which the summation of the individual drawer points must equal the total points for the cabinet housing.)

Useable interior drawer space is 55¹/₈" W x 25¹/₈" D

Drawers (400 lbs. Capacity per drawer)

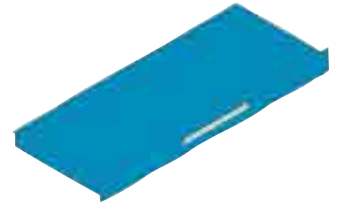
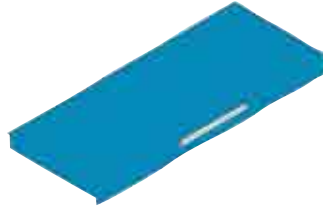
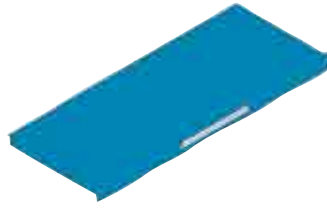
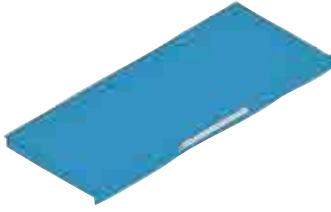

Part No.	Part No.	Part No.	Part No.
8653-10	8653T-12.5	8654-15	8654T-17.5
Height	Height	Height	Height
Front: 3"	Front: 3 ³ / ₄ "	Front: 4 ¹ / ₂ "	Front: 5 ¹ / ₄ "
Body: 2 ¹ / ₈ "	Body: 2 ¹ / ₈ "	Body: 3 ¹ / ₈ "	Body: 3 ¹ / ₈ "
Useable: 2 ¹ / ₄ "	Useable: 3"	Useable: 3 ³ / ₄ "	Useable: 4 ¹ / ₂ "
Points: 10	Points: 12.5	Points: 15	Points: 17.5

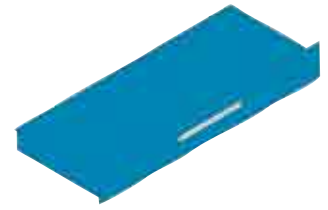
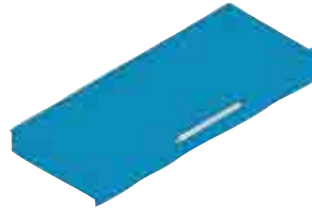
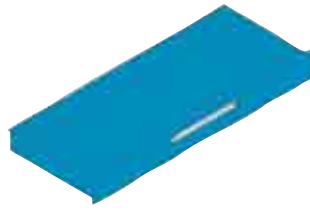
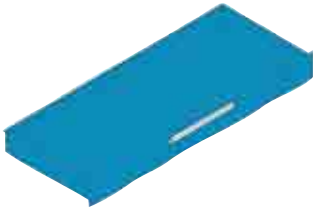

Part No.	Part No.	Part No.	Part No.
8655-20	8655T-22.5	8656-25	8656T-27.5
Height	Height	Height	Height
Front: 6"	Front: 6 ³ / ₄ "	Front: 7 ¹ / ₂ "	Front: 8 ¹ / ₄ "
Body: 4 ⁵ / ₈ "	Body: 4 ⁵ / ₈ "	Body: 4 ⁵ / ₈ "	Body: 4 ⁵ / ₈ "
Useable: 5 ¹ / ₄ "	Useable: 6"	Useable: 6 ³ / ₄ "	Useable: 7 ¹ / ₂ "
Points: 20	Points: 22.5	Points: 25	Points: 27.5

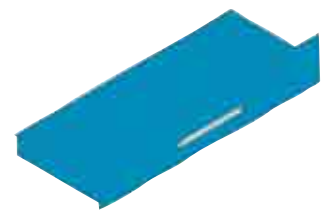
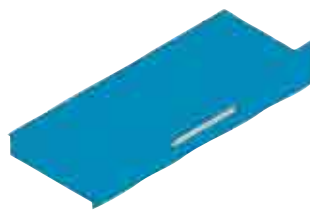

Part No.	Part No.	Part No.	Part No.
8657-30	8657T-32.5	8658-35	8658T-37.5
Height	Height	Height	Height
Front: 9"	Front: 9 ³ / ₄ "	Front: 10 ¹ / ₂ "	Front: 11 ¹ / ₄ "
Body: 4 ⁵ / ₈ "	Body: 4 ⁵ / ₈ "	Body: 4 ⁵ / ₈ "	Body: 4 ⁵ / ₈ "
Useable: 8 ¹ / ₄ "	Useable: 9"	Useable: 9 ³ / ₄ "	Useable: 10 ¹ / ₂ "
Points: 30	Points: 32.5	Points: 35	Points: 37.5

A standard color chart is available at the beginning of each section with a more detailed one on page 126.

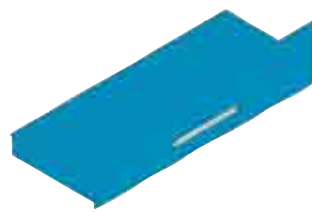
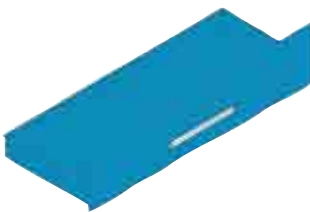
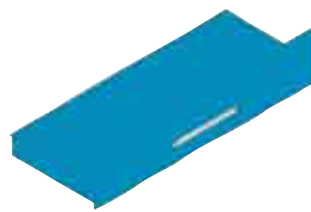
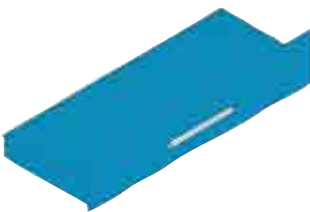

Part No.	Part No.	Part No.	Part No.
8659-40	8659T-42.5	8660-45	8660T-47.5
Height	Height	Height	Height
Front: 12"	Front: 12 ³ / ₄ "	Front: 13 ¹ / ₂ "	Front: 14 ¹ / ₄ "
Body: 4 ⁵ / ₈ "	Body: 4 ⁵ / ₈ "	Body: 4 ⁵ / ₈ "	Body: 4 ⁵ / ₈ "
Useable: 11 ¹ / ₄ "	Useable: 12"	Useable: 12 ³ / ₄ "	Useable: 13 ¹ / ₂ "
Points: 40	Points: 42.5	Points: 45	Points: 47.5

Select divider sets for each drawer

that will help you maximize your storage space within each drawer.
 Divider Sets are optional, and are not required to order a cabinet.
 All dividers are smooth office gray in color.



Divider kits - 60" wide

Divider Set	For 3" High Drawer	For 4 ¹ / ₂ " High Drawer	For 6" High and Up Drawer
Type C	4153C10	4154C15	4155C20
Type D	4153D10	4154D15	4155D20
Type E	4153E10	4154E15	4155E20
Type F	4153F10	4154F15	4155F20
Type H	4153H10	4154H15	4155H20

Modular Drawer Cabinets

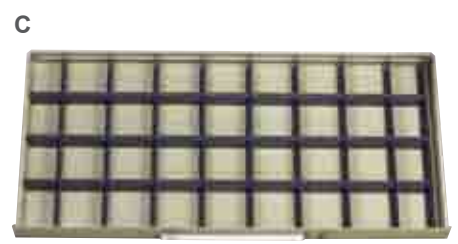

A standard color chart is available at the beginning of each section with a more detailed one on page 126.

Modular Drawer Cabinet Accessories

Accessorize your Equipto Modular Drawer Cabinets. Add dividers, quarter trays, locks, shelves, doors, work surfaces and more to maximize your Equipto System.

Shelves

Stationary or roll-out shelf to be used in conjunction with doors or hinged steel cover that fits flush over modular drawer. Available with optional lock for added drawer security.



Part No.	Description	Use with:
A 8633RS	Steel cover	8633 drawer
8634RS	Steel cover	8634 drawer
8635RS	Steel cover	8635 drawer
13106	Tumbler lock	Steel cover
B 4403R0	30"W Roll-out concealed shelf	Flush door
4403R0-45	45"W Roll-out concealed shelf	Flush door
4403R0-60	60"W Roll-out concealed shelf	Flush door
C 4403C	30"W Adjustable concealed shelf	Flush door
4403C-45	45"W Adjustable concealed shelf	Flush door
4403C-60	60"W Adjustable concealed shelf	Flush door
4405	30" W Stationary Shelf (5 pts.)	External Mount Door
4403RO-22H	22 1/2"W Roll-out concealed shelf	
4403C-22H	22 1/2"W Adjustable shelf	
4403C-3618	36"W x 18"D Adjustable shelf	
4403C-3624	36"W x 24"D Adjustable shelf	
7751-4	Hardware for stacking Modular Drawer Cabinets	
MDCH-CAB	Hardware for connecting side-by-side cabinets (drilling required)	



Door assemblies

Use flush mount doors in conjunction with concealed shelves or use swinging door assemblies over entire cabinet front.

Swinging doors (External mount)

Part No.	For Cabinet
4401	44" H x 30" W
4402	59" H x 30" W
4402-36	59" H x 36" W

Solid hardwood laminated top

Create an excellent work surface or counter top by adding a solid hardwood laminated top to any modular drawer cabinet.

Depth x Length	Part No.
30" x 30"	441-3W
30" x 60"	441-5W
30" x 72"	441-6W

Additional Tops

445-30SSW4	Stainless - 30" W x 27 ³ / ₄ " D
441-3B	Bonded Wood - 30" W x 30" D
445-30SSW4	stainless steel w/ wood core - 27 3/4"D x 30"W x 3/4" thick
445-45SSW4	stainless steel w/ wood core - 27 3/4"D x 45"W x 3/4" thick
445-90SSW4	stainless steel w/ wood core - 27 3/4"D x 90"W x 3/4" thick
MDCC-30S	stainless steel "skin" cover for (1) 30" wide cabinet
MDCC-230S	stainless steel "skin" cover for (2) 30" wide cabinets
MDCC-330S	stainless steel "skin" cover for (3) 30" wide cabinets
MDCC-430S	stainless steel "skin" cover for (4) 30" wide cabinets
MDCC-45S	stainless steel "skin" cover for (1) 45" wide cabinet
MDCC-245S	stainless steel "skin" cover for (2) 45" wide cabinets
MDCC-60S	stainless steel "skin" cover for (1) 60" wide cabinet
MDCC-260S	stainless steel "skin" cover for (2) 60" wide cabinets

*Stainless skin covers are a cost-effective alternative when stainless steel is preferred, but the wood core is not required.

Swinging doors (Flush mount)

For Cabinet Part No.	Width	Height	Points
1 Door			
4197-19	30"	19 ¹ / ₂ "	65
4197-22	30"	22 ¹ / ₂ "	75
4197-24	30"	24"	80
4197-28	30"	28 ¹ / ₂ "	95
4197-33	30"	33"	110
4197-39	30"	39"	130
4197-54	30"	54"	180
2 Doors			
4309SWD	36"	24"	80
44369-18SWD	45"	24"	80
44369SWD	45"	28 ¹ / ₂ "	95
4248SWD	45"	33"	110
4469SWD	45"	39"	130
4479SWD	45"	54"	180
4045	45"	Security Channel*	5
4458SWD	60"	24"	80
4468SWD	60"	28 ¹ / ₂ "	95
4258SWD	60"	33"	110
4449SWD	60"	39"	130
4459SWD	60"	54"	180
4060	60"	Security Channel*	5
4101SLD	Swinging Door Padlock Option		

*Security channels are required when a door is used in combination with drawers.



Modular Drawer Cabinets

A standard color chart is available at the beginning of each section with a more detailed one on page 126.

Equipto's distinct line of Modular Drawer Cabinets represents a true system-within-a-system.



Mobile unit kit

Convert any 22", 30" or 36" wide by 29" or 33 1/2" high modular cabinet to an easy-to-maneuver mobile unit. Kit includes four 6" diameter wheels (2 swivel, 2 rigid), handle and hardware. Lock in Lock out feature, cabinet lock, or both are recommended

- Part No. 4404 22" or 30" wide cabinet 1200 lbs. total capacity
- Part No. 4404-24 36" wide cabinet 1200 lbs. total capacity

Mobile base kits for multiple cabinets

- Part No. 531000-60 For (2) 30"W cabinets
- Part No. 531000-245 For (2) 45"W cabinets
- Part No. 531000-330 For (3) 30"W cabinets
- Part No. MDCH-CAB Side-by-side cabinet hardware

Sloping supervisor desk top

Top is 30" W x 29" D x 6 7/8" H
Part No 294



Cabinet locks

Cabinet Width	Part No.
27 3/4" Depth	
22 1/2", 30", 45" and 60"	4101
22 1/2", 30", 45" and 60"	4101KA (Keyed alike)
18" Depth	
18" x 36"	4101-18
18" x 36"	4101KA-18 (Keyed alike)
24" Depth	
24" x 36"	4101-24
24" x 36"	4101KA-24 (Keyed alike)

Two keys included per lock.

Keys

Master Keys	10429M
Key	10429*

*Specify lock number when ordering



File Drawer

8639HF40, 27" deep, 12" high drawer shown includes hanging file frames (Part No. 10268), letter size, set of two. Holds contents of two file drawers. Optional lock no. 10430 illustrated. Fits 30" wide frames. File drawer holds pendaflex files. 8607FA file drawer holds pendalex folders. 12"H for 18" D by 36" W shelving or cabinets. 8667HFA file drawer for 12" H x 18" D x 48" W shelving or cabinets.

Lock-In Lock-Out feature not available.

EQUIPTO File Cabinets must be floor anchored to prevent tipping over if multiple drawers are opened!

Drawer inserts

Description	For Cabinet Width	Part No.
3/8" Plywood	30"	10116
Rubber Mat	30"	10146
Rubber Mat	22 1/2"	10146-22
Rubber Mat	36" (19" Deep)	10146-36-18
Rubber Mat	36" (25" Deep)	10146-36-24
Rubber Mat	45"	10146-45
Rubber Mat	48" (18" Deep)	10146-48-18
Rubber Mat	48" (24" Deep)	10146-48-24
Rubber Mat	60"	10146-60

Additional Accessories

Description	Part No.
Plastic bins; 2"H x 2"W x 3"L; 30" fill drawer. 96 bins	10122
Plastic bins; 2"H x 3"W x 4"L; 30" fill drawer. 48 bins	10123
Plastic bins; 2 3/4"H x 2"W x 3"L; 30" fill drawer. 96 bins	10124
Plastic bins; 2 3/4"H x 3"W x 4"L; 30" fill drawer. 48 bins	10125
Quarter trays (20 compartments); 1 1/4" x 12 1/2" x 12 1/2"	10120
Quarter trays (35 compartments); 1 1/4" x 12 1/2" x 12 1/2"	10121
Mylar cover strip 18 11/16"L	951102H
Mylar cover strip 21 3/4"L	10106
Paper label 18 11/16"L	951101H
Paper label 21 1/2"L	10107
Modular drawer handle - specify color - (painted same as cabinet)	218907H
Plastic end cap for left side handle	993102L
Plastic end cap for right side handle	993102R
Brushed Aluminum Handle	218908HK
Plastic end cap for Brushed Aluminum left side handle	993102LB
Plastic end cap for Brushed Aluminum right side handle	993102RB
Side-by-side connecting hardware	MDCH-CAB



Hinged locking bars

Cabinet Height	Part. No.	Actual Lock Bar Length
29"	4103-29	23 1/2"
33 1/2"	4103-33	28"
38"	4103-38	32 1/2"
44"	4103-44	38 1/2"
59"	4103-59	53 1/2"

Pad lock or locking device not included.

Plastic bins

Sturdy, plastic bins fit neatly into modular drawers to make counting, sorting and dispensing operations easier, more efficient.

Note: For conductive plastic bins and quarter trays, add C to part number.



Quarter trays

Quarter trays of molded plastic have 20 or 35 compartments to fit inside modular drawers to hold small parts and supplies.

See sizes and Part No. 10120 and 10121 in the chart to the left.

Trays are actually black, but shown in color for depth.

A standard color chart is available at the beginning of each section with a more detailed one on page 126.

Modular Drawer Cabinets

Modular Drawer Cabinet Accessories Continued

All partitions and dividers are smooth office gray in color

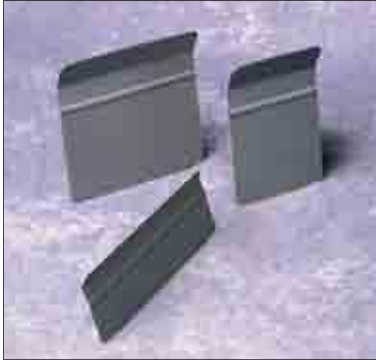

Individual dividers

To further expand the possibilities in creating your own drawer design, we offer a variety of individual dividers. Use them with front-to-back partitions to make compartments of all sizes.

Spaces across drawers:

- 22¹/₂" W — 24 spaces,
- 30" W — 32 spaces,
- 36" W — 40 spaces,
- 45" W — 48 spaces,*
- 60" W — 68 spaces*

*Requires one extra partition per drawer

Dividers

Width	For 3" High Drawers	For 4 ¹ / ₂ " High Drawers	For 6" High and Larger Drawers
Divider Height	2"	3"	4 ¹ / ₂ "
3 ³ / ₃₂ " (4 spaces)	8834	8844	8854
4 ¹¹ / ₁₆ " (6 spaces)	8835	8845	8855
6 ⁹ / ₃₂ " (8 spaces)	8836	8846	8856
7 ⁷ / ₈ " (10 spaces)	8837	8847	8857
9 ⁷ / ₁₆ " (12 spaces)	8838	8848	8858
12 ¹¹ / ₁₆ " (16 spaces)	8839	8849	8859



Electrical power center

Compact, with 4 outlets, On-Off switch, 15 Amp breaker, 15ft. cord with ground. **Easy to install where you need it.**
Power Center #229-4



Leveler Kit

Part No. 10067 - 2 per lift channel required

Equipto announces a leveling feature for modular cabinets. Developed for applications where floors are uneven, the leveling device provides 5/8" of vertical adjustment with a 15-degree swivel foot offering optimum stability. Rated at 1,500 lbs. of static loading, each leveler can accommodate the most stringent loading requirements.

Partitions

Ribbed and slotted partitions fit neatly into drawers, running full depth of drawer from front-to-back. Adjustable in 3/4" increments, they may be used alone, or with dividers. Metal screws supplied for fastening to drawer bottoms. Since some drawers are symmetrical, partitions may also be used from side-to-side.

Full depth partitions (front to back)

Partition Height	To Fit Drawer Height	To Fit 18" Deep Drawers	To Fit 24" Deep Drawers	To Fit 27 ³ / ₄ " Deep Drawers
2"	3"	8780N	8790N	8726
3"	4 ¹ / ₂ "	8781N	8791N	8727
4 ¹ / ₂ "	6" and up	8782N	8792N	8728

Full width partitions (left to right)

Partition Height	To fit Drawer height	To fit Cabinet width	Part. No.
2"	3"	36"	8770
3"	4 1/2"	36"	8771
4 1/2"	6" & up	36"	8772
2"	3"	45"	8743
3"	4 ¹ / ₂ "	45"	8744
4 ¹ / ₂ "	6" & up	45"	8745
2"	3"	60"	8736
3"	4 ¹ / ₂ "	60"	8737
4 ¹ / ₂ "	6" & up	60"	8738



Divider label holder

Label Holder for individual dividers Part No. 6609

Anchor bolt

These bolting options allow you to anchor a modular drawer cabinet to either concrete or wood floors.

Part No.	Description
MDC-CFAK	concrete anchor bolts
MDC-WFAK	wood anchor bolts



MDC-CFAK



MDC-WFAK

Modular Drawer Cabinets

A standard color chart is available at the beginning of each section with a more detailed one on page 126.

Shelving cabinets (60" W x 27³/₄" D)

Description	Part No.
33 ¹ / ₂ " H cabinet with one adjustable shelf	4492
38" H cabinet with one adjustable shelf	46078
44" H cabinet with one adjustable shelf	4493
59" H cabinet with two adjustable shelves	4495
Extra shelf	16300
Sliding doors w/lock	
33 ¹ / ₂ " H for #4492	4490-33
44" H for #4493	4490-44
59" H for #4495	4490-59
Hardwood top	
30" D x 60" W	441-5W

Ships knocked down



Order modular drawers to compliment shelving. Here are typical arrangements. Many more are possible.

- Heavy steel counter units engineered for simple assembly in continuous rows, or easy combination with modular drawer cabinets.
- Ideal for factory issue areas, warehouse or workshop.
- Provides continuous counter space with shelving
- Cabinets come with middle shelf 57" long
- Shelf has capacity of 1000 pounds and adjusts on 1¹/₂" centers
- Optional counter tops available
- Use with modular drawer cabinets to have parts readily available
- See pg 69 for hardware for securing side-by-side cabinets
- Stacking kit 7751-4



Depths and widths are engineered to match up perfectly with modular drawer cabinets. Choose shelving units 33¹/₂" 44" or 59" high, with adjustable shelves (1¹/₂" centers) of removable, ribbed decking. Each shelf offers over 1,000 lbs. capacity for heavy, bulk loads.

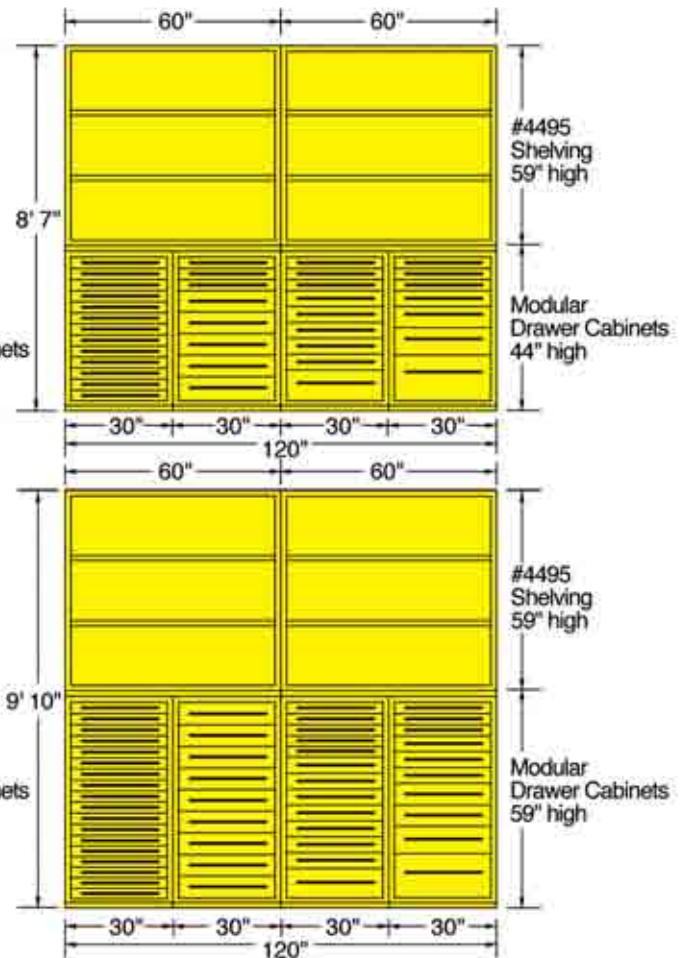
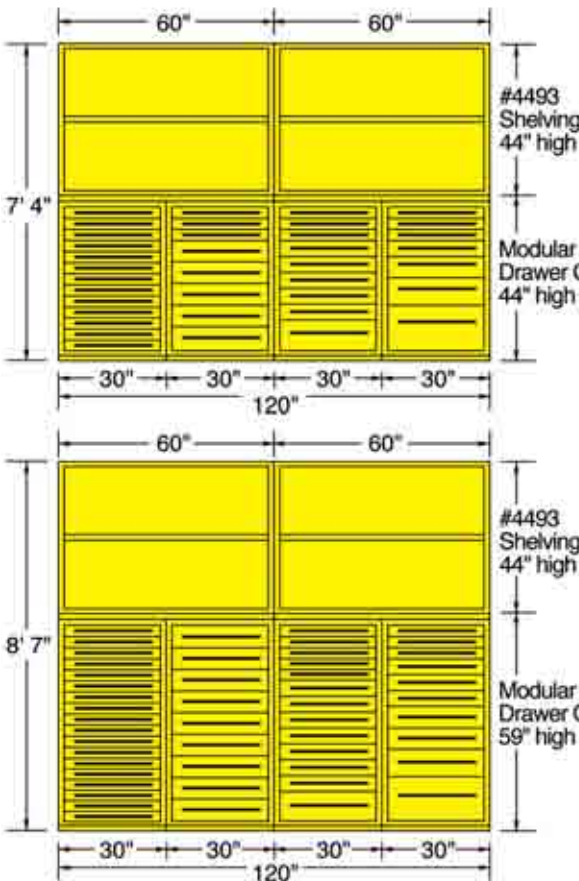

A standard color chart is available at the beginning of each section with a more detailed one on page 126.

Modular Drawer Cabinets

FOD/Heavy Duty Mobile Tool Control Cabinets

Mobile Tool Control Cabinets consist of a single, double or triple modular unit with forklift tubes and a caster base. Can be towed or moved with a forklift. Select from four available tops. Drawers are furnished in eight standard heights and have a 400 lb. capacity. Thumb latches are equipped for safety during transportation. Includes frame, base, casters, top and handle only. Order drawers on pg. 55 and 56. Available drawer height value is 28 1/2"; 95 points.



- Flush doors available in four heights
- Single, double and triple shadow boxes offered
- Lexan panels provide visibility to shadow boxes
- Sliding door frame has roller bearings and lock
- Stainless steel pull handle
- Heavy duty polyurethane tread casters with sealed roller bearings
- Use for foreign object damage (F.O.D.) applications

Shadow box units

Part No.	Description
4195	Type "1" Single Vertical Display 15"D x 30"W x 30"H
4196	Type "2" Double Vertical Display 15"D x 60"W x 30"H

Box is 24 3/8"D at Base.

Foam Inserts

Part No.	Description
010099-1	for 30" wide drawer
010099-2	for 45" wide drawer
010099-3	for 60" wide drawer

Customize your foam inserts to highlight removed tools and help improve tool accountability.



Foreign object damage cabinets

F.O.D. Workstation 30"D overall

Includes frame, base, casters, top and handle only. Order drawers on pg. 53 and 66. Available drawer height value is 28 1/2"; 95 points.

Description:	Part No.
A. Single workstation (not pictured) 30" W	
Plastic laminate top	4191P
Painted steel top	4191PS
Stainless steel top	4191SS
Hardwood top	4191W

B. Double workstation 60" W	
Plastic laminate	4192P
Painted steel	4192PS
Stainless steel	4192SS
Hardwood top	4192W

C. Triple workstation 90" W	
Plastic laminate	4193P
Painted steel	4193PS
Stainless steel	4193SS
Hardwood top	4193W



Modular Drawer Cabinets

Swinging doors (Flush mount)

Part No.	Description	Points
4197-19	19 1/2" high	65
4197-22	22 1/2" high	75
4197-24	24" high	80
4197-28	28 1/2" high	95

Part No.	Description	Use with
4403C	Stationary shelf	Flush door
4403RO	Roll-out concealed shelf	Flush door
4199	Tow bar	Cabinet
4194	Oversize forklift channel	Cabinet

A standard color chart is available at the beginning of each section with a more detailed one on page 126.

Tool Cabinets

Modular Tool Cabinets offer the ability for different storage uses within the same cabinet. With the options including drawers, a door, and a shelf, the uses for a tool cabinet are limitless. Featuring 400 lb drawer capacities, multiple hard top surfaces to choose from, and the ability to add casters for mobility, a tool cabinet is the perfect choice for any application.

- Standard brushed aluminum handles with black end caps
- Single lock system for all drawers
- Doors are keyed differently

Tool Cabinet configurations

Add "M" at end of Part No. = Mobile Units - Includes lock in/lock out feature, casters and push handle. Cabinet locks are included.



Special configuration shown, highlighting an optional lock-in/lock-out drawer feature.

33" H x 60" W x 27 3/4" D		
Part No.	Description	
	Left Cabinet Drawers	Right Cabinet Drawers
MDCDB330104	(1) - 3", (2) - 5 1/4", (1) - 9"	(3) - 3", (2) - 3 3/4", (1) - 6"
MDCDB330203	(2) - 3", (1) - 4 1/2", (1) - 12"	(2) - 3", (1) - 3 3/4", (1) - 5 1/4", (1) - 7 1/2"
MDCDB330303	(2) - 3", (1) - 3 3/4", (1) - 5 1/4", (1) - 7 1/2"	(2) - 3", (1) - 3 3/4", (1) - 5 1/4", (1) - 7 1/2"
MDCDB330404	(3) - 3", (2) - 3 3/4", (1) - 6"	(3) - 3", (2) - 3 3/4", (1) - 6"
MDCDB3302SD0	(2) - 3", (1) - 4 1/2", (1) - 12"	Door, with no shelves
MDCDB3303SD0	(2) - 3", (1) - 3 3/4", (1) - 5 1/4", (1) - 7 1/2"	Door, with no shelves
MDCDB3304SD0	(3) - 3", (2) - 3 3/4", (1) - 6"	Door, with no shelves

38" H x 60" W x 27 3/4" D		
Part No.	Description	
	Left Cabinet Drawers	Right Cabinet Drawers
MDCDB381111	(2) - 4 1/2", (1) - 6", (1) - 12"	(2) - 4 1/2", (1) - 6", (1) - 12"
MDCDB381212	(1) - 4 1/2", (1) - 6", (1) - 7 1/2", (1) - 9"	(1) - 4 1/2", (1) - 6", (1) - 7 1/2", (1) - 9"
MDCDB381311	(1) - 3", (2) - 4 1/2", (1) - 6", (1) - 9"	(2) - 4 1/2", (1) - 6", (1) - 12"
MDCDB381413	(3) - 3", (1) - 4 1/2", (1) - 6", (1) - 7 1/2"	(1) - 3", (2) - 4 1/2", (1) - 6", (1) - 9"
MDCDB381514	(4) - 3", (2) - 4 1/2", (1) - 6"	(3) - 3", (1) - 4 1/2", (1) - 6", (1) - 7 1/2"
MDCDB3814SD1	(3) - 3", (1) - 4 1/2", (1) - 6", (1) - 7 1/2"	(1) - 3" drawer, 2 Shelves, 1 Door
MDCDB3815SD2	(4) - 3", (2) - 4 1/2", (1) - 6"	2 Shelves, 1 Door

44" H x 60" W x 27 3/4" D		
Part No.	Description	
	Left Cabinet Drawers	Right Cabinet Drawers
MDCDB442325	(1) - 4 1/2", (2) - 6", (1) - 7 1/2", (1) - 9"	(3) - 3", (1) - 4 1/2", (2) - 6", (1) - 7 1/2"
MDCDB442424	(1) - 3", (2) - 4 1/2", (2) - 6", (1) - 9"	(1) - 3", (2) - 4 1/2", (2) - 6", (1) - 9"
MDCDB442523	(3) - 3", (1) - 4 1/2", (2) - 6", (1) - 7 1/2"	(1) - 4 1/2", (2) - 6", (1) - 7 1/2", (1) - 9"
MDCDB442622	(4) - 3", (2) - 4 1/2", (2) - 6"	(2) - 4 1/2", (2) - 6", (1) - 12"
MDCDB4427SD4	(4) - 3", (2) - 4 1/2", (2) - 6"	2 Shelves, 1 Door, 1 Lock
MDCDB4425SD3	(3) - 3", (1) - 4 1/2", (2) - 6", (1) - 7 1/2"	(2) - 3" drawers, 2 Shelves, 1 Door
MDCDB4426SD4	(4) - 3", (2) - 4 1/2", (2) - 6"	2 Shelves, 1 Door
MDCDB4425SD4	(3) - 3", (1) - 4 1/2", (2) - 6", (1) - 7 1/2"	2 Shelves, 1 Door

59" H x 60" W x 27 3/4" D		
Part No.	Description	
	Left Cabinet Drawers	Right Cabinet Drawers
MDCDB593236	(1) - 3", (1) - 4 1/2", (2) - 6", (1) - 7 1/2", (1) - 9", (1) - 12"	(4) - 3", (2) - 4 1/2", (1) - 6", (1) - 7 1/2", (1) - 13 1/2"
MDCDB593335	(1) - 4 1/2", (2) - 6", (3) - 7 1/2", (1) - 9"	(3) - 3", (1) - 4 1/2", (2) - 6", (1) - 9", (1) - 13 1/2"
MDCDB593434	(1) - 3", (2) - 4 1/2", (2) - 6", (2) - 7 1/2", (1) - 9"	(1) - 3", (2) - 4 1/2", (2) - 6", (2) - 7 1/2", (1) - 9"
MDCDB593533	(3) - 3", (1) - 4 1/2", (2) - 6", (1) - 9", (1) - 13 1/2"	(1) - 4 1/2", (2) - 6", (3) - 7 1/2", (1) - 9"
MDCDB593632	(4) - 3", (2) - 4 1/2", (1) - 6", (1) - 7 1/2", (1) - 13 1/2"	(1) - 3", (1) - 4 1/2", (2) - 6", (1) - 7 1/2", (1) - 9", (1) - 12"
MDCDB5935SD5	(3) - 3", (1) - 4 1/2", (2) - 6", (1) - 9", (1) - 13 1/2"	(1) - 3" drawer, 2 Shelves, 1 Door
MDCDB5936SD6	(4) - 3", (2) - 4 1/2", (1) - 6", (1) - 7 1/2", (1) - 13 1/2"	(2) - 3" drawer, 2 Shelves, 1 Door
MDCDB5934SD7	(1) - 3", (2) - 4 1/2", (2) - 6", (2) - 7 1/2", (1) - 9"	2 Shelves, 1 Door

Contact Equipto
for custom configuration options.

Accessories	
Stainless Steel Top	MDCC-60S
Double Bank Cabinet Lock	4101DB

A standard color chart is available at the beginning of each section with a more detailed one on page 126.

Modular Drawer Cabinets